

## 8C-2 INSTRUMENT PANEL, GAGES AND CONSOLE

Performance Switch (V8 Automatic) Second Gear Start Switch (V6 Automatic) .....	8C-17
Traction Control Switches .....	8C-17
Storage Tray .....	8C-18
Transmission Plate Assembly .....	8C-18
Heat, Ventilation and Air Conditioning Ducts .....	8C-18
Air Distributor Assembly .....	8C-18
Center Air Outlet Duct Assemblies .....	8C-20
Defogger Outlet Duct Assembly .....	8C-20
Floor Air Outlet Duct Assembly .....	8C-21
Outer Air Outlet Duct Assemblies .....	8C-21
Instrument Cluster Assembly .....	8C-21
Instrument Panel Carrier .....	8C-21
Instrument Panel Insulator .....	8C-24
Instrument Panel Switches .....	8C-24
Headlamp and Instrument Panel Lamp Dimmer Switch Assembly .....	8C-24
Lid Release Switch Assembly .....	8C-25
Instrument Panel Wiring Harness Assembly ..	8C-26
Auxiliary Fuse Block .....	8C-26

Convenience Center .....	8C-27
Express Down Module .....	8C-27
Retained Accessory Power (RAP) Module ...	8C-28
Odometer Repair Notice Label .....	8C-29
Sound Insulator Assembly .....	8C-29
Trim Panel Cluster Bezel Assembly, Upper Trim Panel Assembly and Compartments ..	8C-30
Instrument Panel Cluster Trim Plate Bezel Assembly .....	8C-30
Instrument Panel Compartment .....	8C-31
Instrument Panel Compartment Door Lock Cylinder Assembly .....	8C-31
Instrument Panel Fuse Block Access Door Assembly .....	8C-33
Instrument Panel Upper Trim Panel Assembly .....	8C-33
Passenger Side Inflator Module Assembly ...	8C-34
Warning/Reminder Chimes .....	8C-34
Alarm Assembly .....	8C-34
Specifications .....	8C-34
Fastener Tightening Specifications .....	8C-34

## GENERAL DESCRIPTION

### AUXILIARY FUSE BLOCK

The fuse block is a part of the body wiring harness assembly. It is attached by a bracket on the left front hinge pillar and is accessed through a removable panel on the instrument panel carrier.

For diagnosis, refer to SECTION 8A.

### CONVENIENCE CENTER

The convenience center is part of the body wiring harness assembly. It is attached to a bracket located on the cowl below the instrument panel carrier to the left of the steering column assembly.

The audio alarm assembly, vehicle speed sensor (VSS) buffer, and hazard lamp flasher are attached to the convenience center. The turn signal lamp flasher is opposite the convenience center to the right of the steering column assembly and the knee bolster bracket.

For diagnosis of the convenience center and components, refer to SECTION 8A.

### DAYTIME RUNNING LAMPS (DRL) (CANADIAN ONLY)

All Canadian vehicles are equipped with daytime running lamps. The daytime running lamp system includes a solid state module and a light sensor. The system lights the park lamps when the ignition switch is in the "RUN" position during daylight. The daytime running lamp system is designed to light the low-beam headlamps at full intensity, and the parking and taillamps when low light conditions are present.

### EXPRESS DOWN

Express Down fully lowers the driver's front side door window when the side window switch is pressed quickly and released.

## RETAINED ACCESSORY POWER (RAP)

If the vehicle is equipped with Power door locks, the vehicle has a feature called Retained Accessory Power (RAP). With RAP the power door locks, electric mirrors, power windows, audio system and remote hatch release will continue to work up to 10 minutes after the ignition key is turned to "Off" and neither door is opened.

If a door is opened, the audio system and power windows will shut off. The power door locks, electric mirrors and remote hatch release will work until you shut the door. Once you have shut the door, these accessories will continue to work for approximately 35 seconds. After this time you will not be able to use these accessories until the next time you open a door or turn on the ignition.

## FRONT FLOOR CONSOLE ASSEMBLY

The console assembly fits over the tunnel in the floor of the vehicle and extends from under the center of the instrument panel assembly to the rear seat area. The console assembly consists of two major assemblies. The lower console assembly forms the side and rear walls of the complete console structure, while the upper console assembly forms the top of the structure.

The upper console assembly has a cigarette lighter and an ashtray with a coinholder and mat, or a cassette holder. The upper console assembly also houses the transmission shift lever. For vehicles without the cassette holder in the upper console area, the cigarette lighter and ashtray are set just below the transmission shift lever in the center of the console assembly. The parking brake is in a recess in the right side of the console assembly.

Below the transmission shift lever, toward the rear of the vehicle, is a cupholder with a mat. In the rear of the console assembly is a storage compartment. The storage compartment contains a tray for cassette tapes or compact discs. The storage compartment has a padded door that serves as a front seat center armrest.

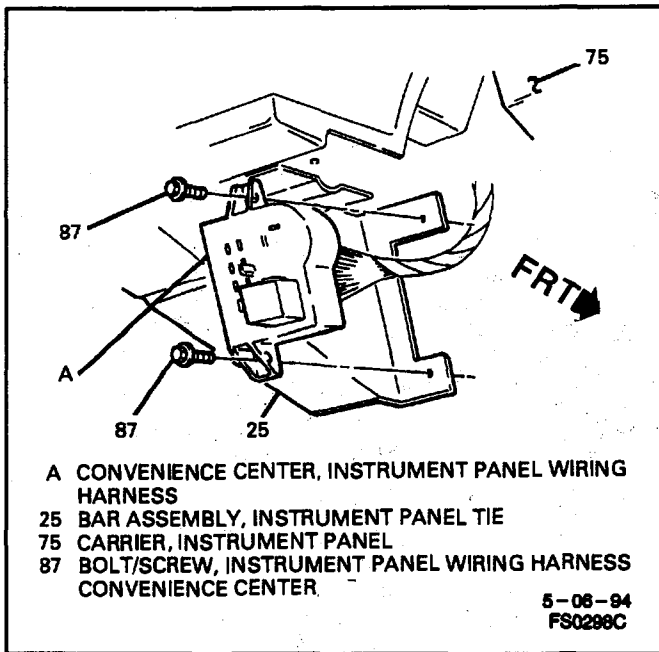

Figure 28 – Convenience Center

1. Left side sound insulator panel. Refer to “Sound Insulator Assembly” in this section.
2. Express down module.
3. Wiring harness electrical connector from express down module.

**Install or Connect**

1. Wiring harness electrical connector to express down module.
2. Express down module.
3. Left side sound insulator panel Refer to “Sound Insulator Assembly” in this section.

**RETAINED ACCESSORY POWER (RAP) MODULE**

Figure 29

**Remove or Disconnect**

**CAUTION: See “Caution” on page 8C-1 of this section.**

1. Left side sound insulator panel. Refer to “Sound Insulator Assembly” in this section.
2. Retained accessory power module from pocket molded in dash mat.
3. Wiring harness electrical connector from retained accessory power module.

**Install or Connect**

1. Wiring harness electrical connector to retained accessory power module.

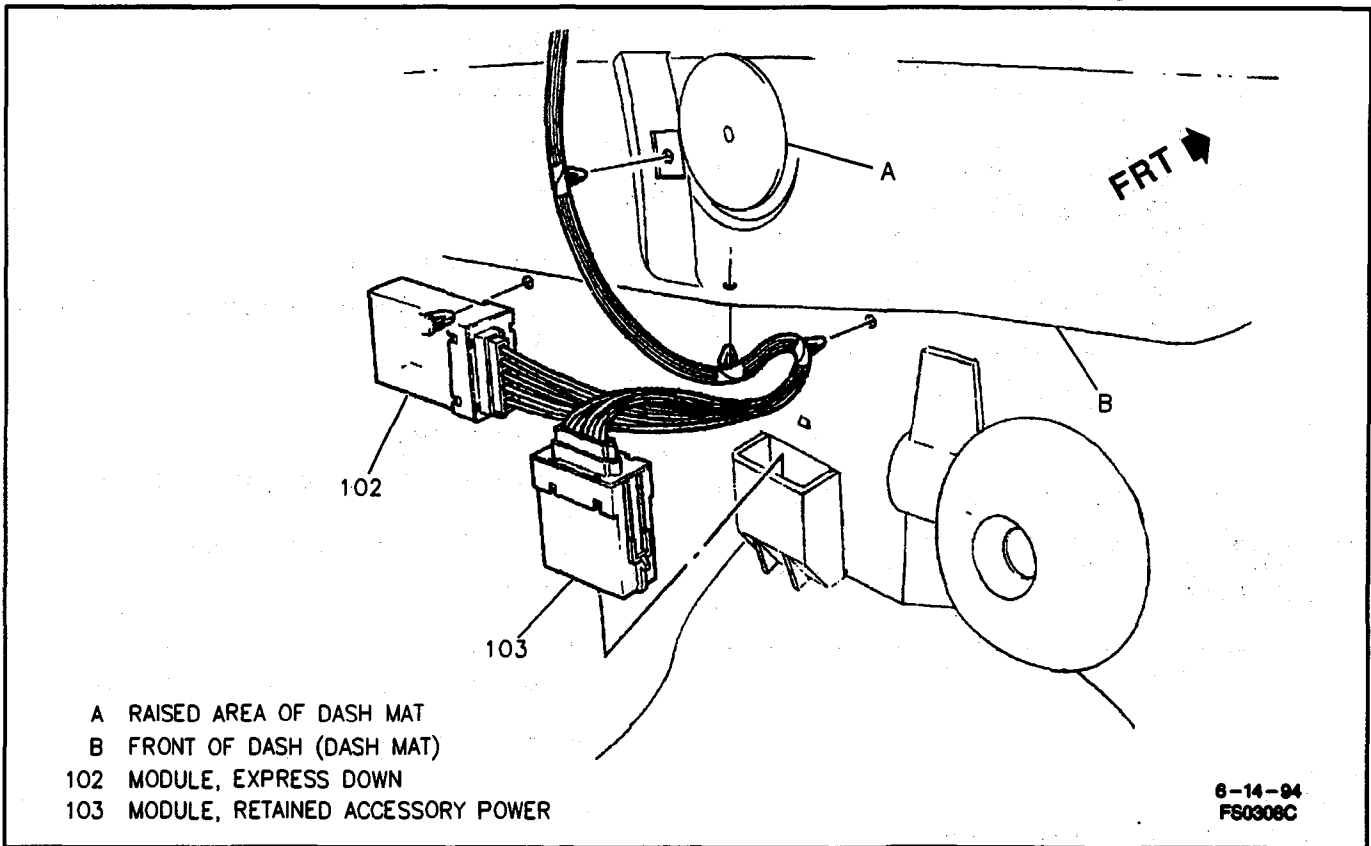

Figure 29 – Express Down and Retained Accessory Power (RAP) Modules

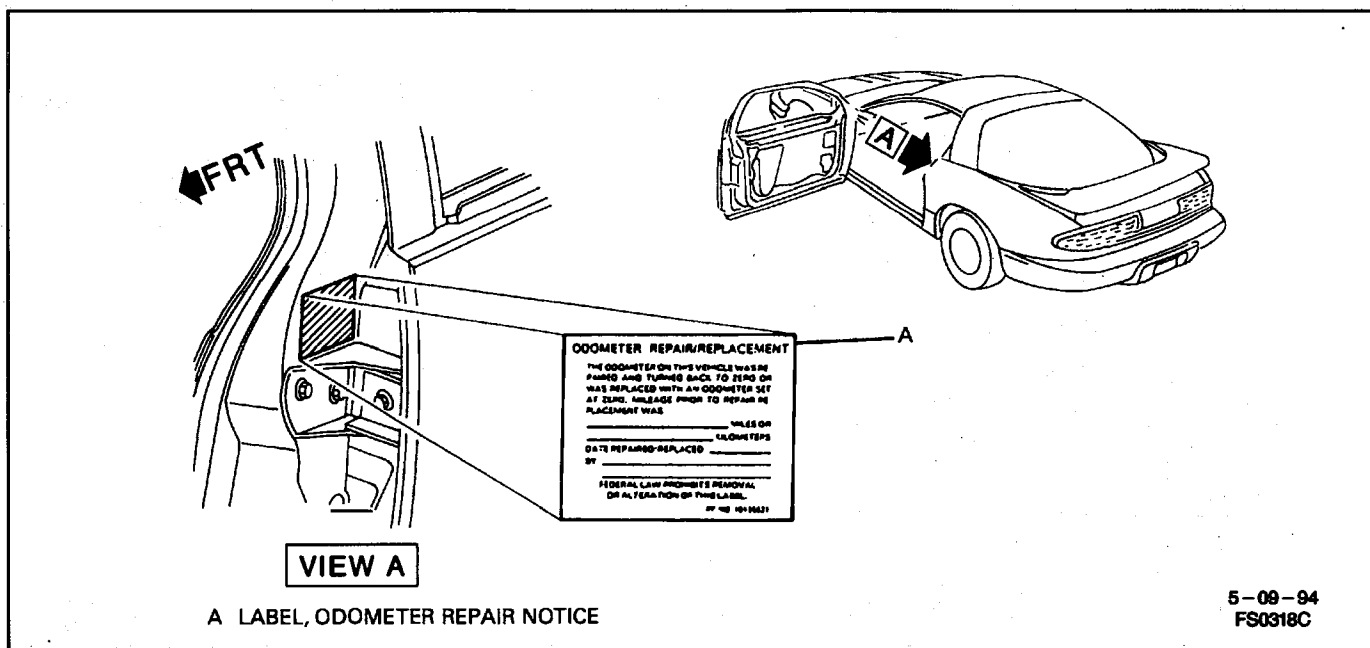

Figure 30 – Odometer Repair Notice Label

2. Retained accessory power module to pocket molded in dash mat.
3. Left side sound insulator panel. Refer to “Sound Insulator Assembly” in this section.

2. Properly fill out all necessary information on odometer repair notice label.
  - Sign and date odometer repair notice label.
3. Remove backing and attach odometer repair notice label to left B-pillar.

### ODOMETER REPAIR NOTICE LABEL

Figure 30

#### Important

- When repairing an instrument cluster assembly, the law requires the odometer reading of the replacement unit to be set to register the same mileage as the prior odometer. If the same mileage cannot be set, the law requires that the replacement odometer be set to zero and a label be installed on the driver’s door frame to show the previous reading and the date of replacement.
- A copy of the label must be retained in compliance with the retention requirements specified in the “Guidelines for General Motors Odometer Policy.”

#### Install or Connect

1. Clean area around left B-pillar where odometer repair notice label is to be attached.
  - Label area is to be clean and free from plastisol or any foreign material that could affect adhesion of odometer repair notice label.

### SOUND INSULATOR ASSEMBLY

Figure 31

#### Left Side

#### Remove or Disconnect

1. Retainer (13) from instrument panel carrier.
2. Insulator assembly (14) from instrument panel carrier.
  - A. Unhook flange on insulator assembly (14) from side kick panel assembly.
  - B. Detach tab on insulator assembly (14) from retainer on instrument panel carrier.

#### Install or Connect

1. Insulator assembly (14) to instrument panel carrier.
  - A. Attach tab on insulator assembly (14) to retainer on instrument panel carrier.
  - B. Hook flange on insulator assembly (14) to side kick panel assembly.
2. Retainer (13) to instrument panel carrier.



**C200D**

**I/P HARNESS TO FORWARD  
LAMP/CROSS CAR HARNESS**

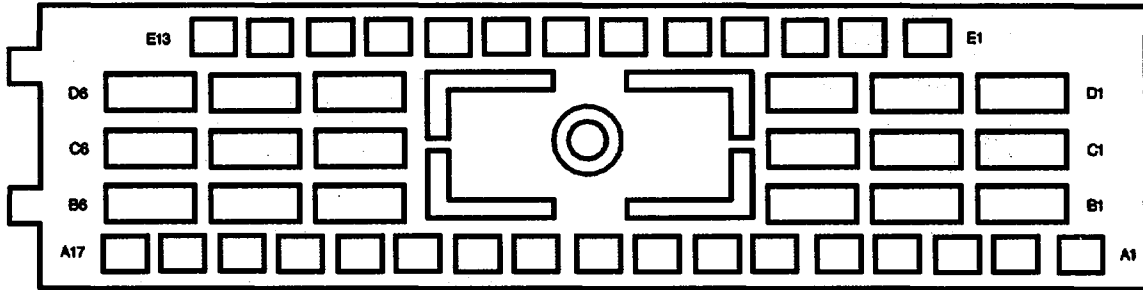

**12077822**

**48 - WAY M METRI - PACK MIXED SERIES  
BLK**

**M - CONNECTOR  
F - TERMINAL**

**C200A**

**FORWARD LAMP HARNESS TO  
I/P HARNESS**



**12047842**

**17 WAY F METRI - PACK 150 SERIES  
BLK**

**C200B**

**FORWARD LAMP HARNESS TO  
I/P HARNESS**

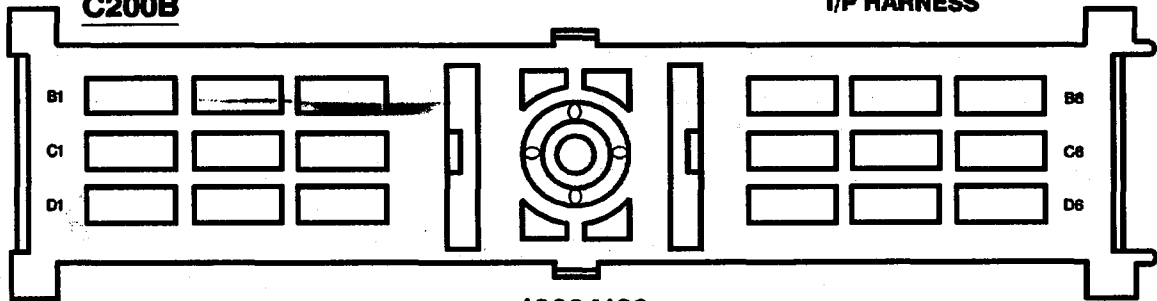

**12084183**

**18 - WAY F METRI - PACK MIXED SERIES  
BLK**

**C200C**

**CROSS CAR HARNESS TO  
I/P HARNESS**



**12047840**

**13 - WAY F METRI - PACK 280 SERIES  
GRY**

RETAINED ACCESSORY POWER (RAP): WITH AU3

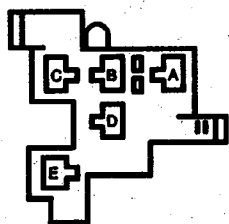

12010966

5-WAY F 56 SERIES  
BLU

IGNITION SWITCH (C2)

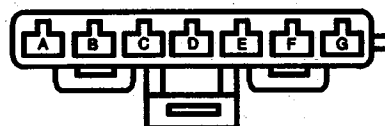

12052854

7-WAY F METRI-PACK 280 SERIES  
BLK

RETAINED ACCESSORY POWER (RAP) MODULE

5-14-84  
FS0028A015

COMPONENT	LOCATION	201-PG	FIG.	CONN
Door Jamb Switch, LH.....	Near base of LH "A" pillar.....	44.....	83	
Door Jamb Switch, RH.....	Near base of RH "A" pillar.....	32.....	49	
I/P Fuse Block.....	LH side of I/P Carrier, on the side.....	8.....	15.....	202-16
Ignition Switch.....	Part of Steering Column.....	34.....	63.....	202-16
Isolation Diode (RAP).....	Sealed in Harn, approx 9 cm right of Rearview Mirror breakout.....	44.....	83	
Retained Accessory Power (RAP) Module.....	In molded pocket of dash mat, center above floor tunnel.....	9.....	17.....	202-21
C200B (18 cavities).....	Forward Lamp to I/P Harn, between LH kick panel and Steering Column.....	25.....	49.....	202-3
C200C (13 cavities).....	Cross Car to I/P Harn, between LH kick panel and Steering Column.....	25.....	49.....	202-3
C200D (48 cavities).....	Part of I/P Harn, between LH kick panel and Steering Column.....	25.....	49.....	202-3
G200.....	Near base of LH "A" pillar, bolted to I/P Mounting Stud behind kick panel (2 rings, 2 wires).....	9.....	16	
P100.....	Left side in dash panel, Engine to Passenger Compartment... ..	19.....	36	
S200.....	Forward Lamp Harn, approx 5 cm from EBCM breakout.....	8.....	14	
S220.....	Cross Car Harn, approx 9 cm from C200 breakout.....	44.....	83	
S266.....	Cross Car Harn, approx 9 cm from Rearview Mirror breakout.....	44.....	83	

For a Service Part Cross Reference List and Information, refer to SECTION 8A-200.

**TROUBLESHOOTING HINTS  
(Perform before beginning System Diagnosis)**

1. Check Fusible Link E for open.
2. Check Window Circuit Breaker 15, Radio Fuse 17 and PWR ACCY Fuse 7 for an open. If open, replace fuse or circuit breaker. If fuse blows again or circuit breaker reopens, use schematics and DVM to check suspect power circuits for a short to ground potential, either through a faulty component or wiring.
3. Check for poor connections at C200 terminals "C1", "E2", "E4", "E6" and "E12".
4. Check that G200 is clean and tight.
  - Check for a broken (or partially broken) wire inside of the insulation which could cause system

malfunction but prove "GOOD" in a continuity/voltage check with a system disconnected. These circuits may be intermittent or resistive when loaded, and if possible, should be checked by monitoring for a voltage drop with the system operational (under load).

- Check for proper installation of aftermarket electronic equipment which may affect the integrity of other systems (see "Troubleshooting Procedures," page 8A-4-0).
- Refer to System Diagnosis.

**SYSTEM DIAGNOSIS**

- Perform the System Check and refer to the Symptom Table for the appropriate diagnostic procedures.

**SYSTEM CHECK**

ACTION	NORMAL RESULTS
[1] • Ignition "OFF." • Open either LH or RH door.	• Power Door Locks, Hatch Release and Power Mirrors all operate as long as a door is open. • Radio and Power Windows do not operate.
[2] • Close doors.	• Power Door Locks, Hatch Release and Power Mirrors all continue to operate for approximately 35 seconds. • Radio and Power Windows do not operate.
[3] • Ignition Switch to "ACCY" or "RUN."	• Power Door Locks, Hatch Release and Power Mirrors all operate as long as the Ignition Switch is in "ACCY" or "RUN." • Radio and Power Windows operate as long as the Ignition Switch is in "ACCY" or "RUN."
[4] • Ignition Switch to "OFF."	• Power Door Locks, Hatch Release and Power Mirrors all operate for approximately 10 minutes. • Radio and Power Windows operate for approximately 10 minutes.
[5] • Ignition Switch to "RUN." • Ignition Switch to "OFF." • Open either LH or RH door.	• Power Door Locks, Hatch Release and Power Mirrors all operate as long as a door is open. • Radio and Power Windows are disabled immediately when a door is opened.
[6] • Close doors.	• Power Door Locks, Hatch Release and Power Mirrors all continue to operate for approximately 35 seconds. • Radio and Power Windows do not operate.

**RETAINED ACCESSORY POWER (RAP): WITH AU3**

**! Important:**

- If aftermarket equipment is installed on any circuit(s) for the Retained Accessory Power (RAP) System and a problem exists with the Retained Accessory Power System operation, disconnect the aftermarket equipment and retest.

- These diagnostic procedures assume related fuse(s) or circuit breaker(s) and the circuitry to their related components are all good.

**SYMPTOM TABLE**

SYMPTOM	PROCEDURE	PAGE NUMBER
Components on PWR ACCY Fuse 7, Radio Fuse 17 and Windows Circuit Breaker 15 totally inoperative.	Chart #1	8A-15-6
Retained Accessory Power (RAP) Feature inoperative, components on PWR ACCY Fuse 7, Radio Fuse 17 and Windows Circuit Breaker 15 operate with Ignition Switch in "RUN" or "ACCY" only.	Chart #2	8A-15-7
Components on Windows Circuit Breaker 15 and Radio Fuse 17 totally inoperative, components on PWR ACCY Fuse 7 operate normally.	Chart #3	8A-15-7
Components on Windows Circuit Breaker 15 and Radio Fuse 17 do not operate during Retained Accessory Power (RAP), operation is normal with Ignition Switch in "ACCY" or "RUN" (components on PWR ACCY Fuse 7 operate normally during RAP).	Replace Retained Accessory Power (RAP) Module.	
Components on PWR ACCY Fuse 7 totally inoperative, components on Windows Circuit Breaker 15 and Radio Fuse 17 operate normally.	Chart #4	8A-15-8
Components on PWR ACCY Fuse 7 do not operate during Retained Accessory Power (RAP), operation is normal with Ignition Switch in "ACCY" or "RUN" (components on Windows Circuit Breaker 15 and Radio Fuse 17 operate normally during RAP).	Replace Retained Accessory Power (RAP) Module.	
Retained Accessory Power (RAP) deactivates when another vehicle system is used (otherwise RAP times out normally).	<ul style="list-style-type: none"> <li>• If use of Interior Lights causes deactivation of Retained Accessory Power (RAP), check Isolation Diode (RAP).</li> <li>• Narrow in on system causing deactivation and shield or filter power and grounds to component, then retest system.</li> <li>• If unable to correct complaint, contact technical assistance.</li> </ul>	



## SYMPTOM TABLE (Continued)

SYMPTOM	PROCEDURE	PAGE NUMBER
Retained Accessory Power (RAP) deactivates before specified time has elapsed (deactivation not caused by the use of other vehicle systems).	<ul style="list-style-type: none"> <li>• Refer to System Check to make sure the RAP System is not operating properly.</li> <li>• Check for technical service bulletins.</li> <li>• If above checks do not correct symptom, replace Retained Accessory Power (RAP) Module.</li> </ul>	
PWR ACCY Fuse 7 receives voltage continuously (past the approximately 10 minute period) with doors closed and Ignition Switch in "OFF."	<ul style="list-style-type: none"> <li>• Check for short to B+ in CKT 70.</li> <li>• Check for short to ground through CKT 745, including a bad Door Jamb Switch.</li> <li>• Check for poor connections at RAP Module Connector.</li> <li>• If OK, replace Retained Accessory Power (RAP) Module.</li> </ul>	
Radio Fuse 17 and Windows Circuit Breaker 15 receive voltage continuously (past the approximately 10 minute period) with doors open and Ignition Switch in "OFF."	<ul style="list-style-type: none"> <li>• Check for short to B+ in CKT 75.</li> <li>• If OK, replace Retained Accessory Power (RAP) Module.</li> </ul>	
<ul style="list-style-type: none"> <li>• Power Door Locks do not operate when one or both doors are opened.</li> <li>• Power Door Locks only operate with Ignition "ON," or for 10 minutes after Ignition is turned "OFF." (Opening the door does not disable the 10 minute timer or enable "PWR ACCY" Fuse 7.)</li> </ul>	<ul style="list-style-type: none"> <li>• Check for bad Door Jamb Switch on side of entry.</li> <li>• Check for open in CKT 745.</li> <li>• Check for poor connection at RAP Module.</li> <li>• If OK, replace Retained Accessory Power (RAP) Module.</li> </ul>	

RETAINED ACCESSORY POWER (RAP): WITH AU3

CHART #1  
 COMPONENTS ON PWR ACCY FUSE 7, RADIO FUSE 17  
 AND WINDOWS CIRCUIT BREAKER 15 TOTALLY INOPERATIVE



**IMPORTANT:**

- THIS CHART ASSUMES RELATED FUSE(S) OR CIRCUIT BREAKER(S) AND THE CIRCUITRY TO THEIR RELATED COMPONENTS ARE ALL GOOD, AND INSTALLED AFTERMARKET EQUIPMENT IS NOT A PROBLEM.

• IGNITION SWITCH TO "RUN."  
 • WITH A TEST LIGHT TO GROUND, BACKPROBE RETAINED ACCESSORY POWER (RAP) MODULE CONN TERM "D". IS TEST LIGHT "ON"?

NO

• WITH A TEST LIGHT TO GROUND, BACKPROBE IGNITION SWITCH CONN C2 TERM "B". IS TEST LIGHT "ON"?

YES

• WITH A TEST LIGHT TO GROUND, BACKPROBE IGNITION SWITCH CONN C2 TERM "E". IS TEST LIGHT "ON"?

YES

• CHECK FOR POOR CONNECTION AT C200 TERM "C6" AND TERM "E2". IF OK, REPAIR OPEN IN CKT 4 BETWEEN IGNITION SWITCH AND RETAINED ACCESSORY POWER (RAP) MODULE.

NO

• CHECK FOR OPEN IN FUSIBLE LINK "E". IF OK, REPAIR OPEN IN CKT 102 BETWEEN IGNITION SWITCH AND FUSIBLE LINK.

NO

• CHECK FOR POOR CONNECTION AT IGNITION SWITCH. IF OK, REPLACE IGNITION SWITCH.

YES

**CHECK FOR:**

- POOR CONNECTIONS AT RETAINED ACCESSORY POWER (RAP) MODULE CONNECTOR.
- POOR CONNECTIONS AT C200 TERM "E6" AND TERM "E12".
- WIRING DAMAGE THAT MAY CAUSE AN OPEN IN CKT 70 AND CKT 75. IF ABOVE CHECKS ARE OK, REPLACE RETAINED ACCESSORY POWER (RAP) MODULE.

**CHART #2**  
**RETAINED ACCESSORY POWER (RAP) FEATURE INOPERATIVE, COMPONENTS ON PWR ACCY FUSE 7, RADIO FUSE 17 AND WINDOWS CIRCUIT BREAKER 15 OPERATE WITH IGNITION SWITCH IN "RUN" OR "ACCY" ONLY**



**IMPORTANT:**

- THIS CHART ASSUMES RELATED FUSE(S) OR CIRCUIT BREAKER(S) AND THE CIRCUITRY TO THEIR RELATED COMPONENTS ARE ALL GOOD, AND INSTALLED AFTERMARKET EQUIPMENT IS NOT A PROBLEM.

• WITH A TEST LIGHT TO GROUND, BACKPROBE RETAINED ACCESSORY POWER (RAP) MODULE CONN TERM "C". IS TEST LIGHT "ON"?

YES

• DISCONNECT RETAINED ACCESSORY POWER (RAP) MODULE CONNECTOR.  
 • CONNECT A TEST LIGHT BETWEEN TERMINALS "C" AND "E" OF THE RAP MODULE CONNECTOR.  
 IS TEST LIGHT "ON"?

YES

• CHECK FOR POOR CONNECTIONS AT RETAINED ACCESSORY POWER (RAP) MODULE CONNECTOR.  
 • IF OK, REPLACE RETAINED ACCESSORY POWER MODULE. (IF POWER ACCY FUSE RECEIVES VOLTAGE CONTINUOUSLY WITH DOORS CLOSED AND IGNITION SWITCH "OFF," CHECK FOR A SHORT TO GROUND THROUGH CKT 745, INCLUDING A BAD RAP ISOLATION DIODE OR DOOR JAMB SWITCH.)

NO

• CHECK FOR POOR CONNECTION AT C200 TERM "C1" AND TERM "E4".  
 IF OK, REPAIR OPEN IN CKT 102 BETWEEN RETAINED ACCESSORY POWER (RAP) MODULE CONNECTOR AND S200.

NO

• CHECK FOR POOR CONNECTIONS AT RAP MODULE CONNECTOR.  
 • IF OK, CHECK FOR OPEN IN CKT 750 BETWEEN RAP MODULE AND G200.

C1257S

**CHART #3**  
**COMPONENTS ON WINDOWS CIRCUIT BREAKER 15 AND RADIO FUSE 17 TOTALLY INOPERATIVE, COMPONENTS ON PWR ACCY FUSE 7 OPERATE NORMALLY**



**IMPORTANT:**

- THIS CHART ASSUMES RELATED FUSE(S) OR CIRCUIT BREAKER(S) AND THE CIRCUITRY TO THEIR RELATED COMPONENTS ARE ALL GOOD, AND INSTALLED AFTERMARKET EQUIPMENT IS NOT A PROBLEM.

• IGNITION SWITCH TO "RUN."  
 • WITH A TEST LIGHT TO GROUND, FRONTPROBE RADIO FUSE 17.  
 IS TEST LIGHT "ON"?

NO

• WITH A TEST LIGHT TO GROUND, BACKPROBE RAP MODULE CONN TERM "B".  
 IS TEST LIGHT "ON"?

NO

• CHECK FOR POOR CONNECTION AT RAP MODULE CONN TERM "B"  
 IF OK, REPLACE RAP MODULE.

YES

• CHECK I/P FUSE BLOCK FOR POOR WIRE CONNECTIONS OR POSSIBLE DAMAGE  
 • IF OK, REFER TO "RADIO," PAGE 8A-150-0

YES

• CHECK FOR POOR CONNECTION AT C200 TERM "E6".  
 IF OK, REPAIR OPEN IN CKT 75 BETWEEN RAP MODULE CONNECTOR AND I/P FUSE BLOCK.

C2603S

**RETAINED ACCESSORY POWER (RAP): WITH AU3**

**CHART #4**  
**COMPONENTS ON PWR ACCY FUSE 7 TOTALLY INOPERATIVE, COMPONENTS ON**  
**WINDOWS CIRCUIT BREAKER 15 AND RADIO FUSE 17 OPERATE NORMALLY**



**IMPORTANT:**

- THIS CHART ASSUMES RELATED FUSE(S) OR CIRCUIT BREAKER(S) AND THE CIRCUITRY TO THEIR RELATED COMPONENTS ARE ALL GOOD, AND INSTALLED AFTERMARKET EQUIPMENT IS NOT A PROBLEM.

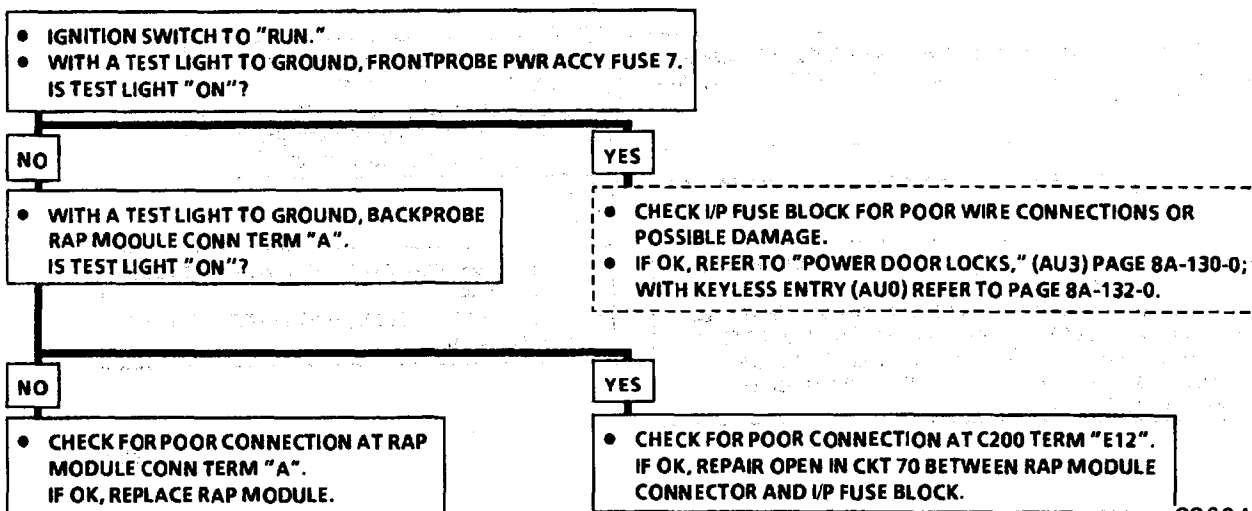

C2604S

**CIRCUIT OPERATION**

The Retained Accessory Power (RAP) System is designed to increase convenience and provide increased security. Some Vehicle Systems will remain operational for approximately 10 minutes after the Ignition Switch is turned to "OFF" or until a door is opened. Other systems will also be operational with Ignition Switch "OFF" whenever a door is open or for approximately 35 seconds after both doors are closed.

**PWR ACCY FUSE 7 OPERATION**

The Retained Accessory Power (RAP) Module will enable the Power Door Locks, Hatch Release and Power Mirrors to operate with the Ignition Switch in "OFF" whenever either door is open or for 35 seconds after both doors are closed. All components on this circuit will be enabled as long as the Ignition Switch is in "ACCY" or

"RUN." After the Ignition Switch is turned to "OFF" and both doors remain closed, the components on this circuit will be enabled for approximately 10 minutes. If either door opens, the 10 minute timer cancels, and the components remain enabled as long as a door is opened.

**RADIO FUSE 17 AND WINDOWS CIRCUIT BREAKER OPERATION**

The Retained Accessory Power (RAP) Module will enable the Radio, Power Windows and Convertible Top to operate whenever the Ignition Switch is in "ACCY" or "RUN." After the Ignition Switch is turned to "OFF" and both doors remain closed, the Radio, Power Windows and Convertible Top will be enabled for approximately 10 minutes. If either door opens, these components will be disabled immediately.